

Safe and sound.

To develop the lounger, we examined the various causes of babies' discomfort and parents' worries. Under the surface our simple, safe solution is stuffed full of technical and engineering know-how.

We took care of the details to help you take care of baby.

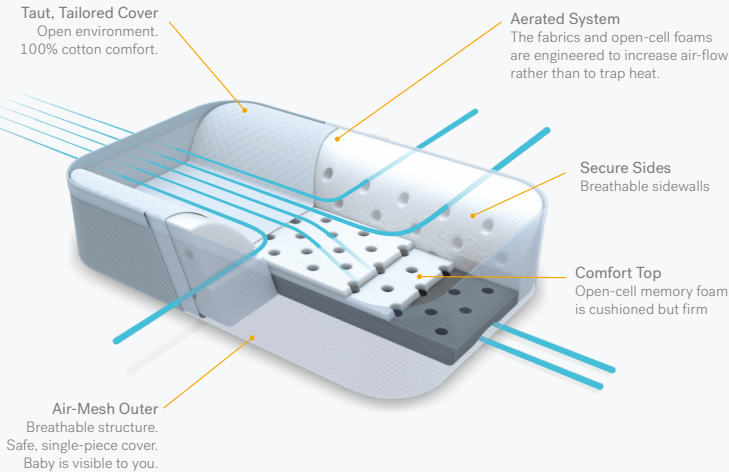



Relax. This is a safe space.

Grown-ups love soft, cozy pillows but babies have much different needs. Babies need a flat surface that provides firm, comfortable support.

Temperature control is an issue for babies, who should not be allowed get too hot or too cold. The aerated base and Air Tunnel System was developed to keep baby cool and to invite a healthy circulation of air throughout the lounger.

The lounger is ideal for newborns and up to 6 months old or when your baby starts rolling over. Do not leave loose or bunched material in the lounger near the baby.

 **Reduces Risk of Overheating**
For comfort and peace of mind

 **Air Tunnel System**
Keeps baby at a comfortable temperature

 **Firm, yet Comfy Memory Foam**
Baby-safe open-cell foam layers

 **Convenient handle & pockets**
To keep baby essentials nearby

 **Taut Tailored Cover**
Open and safe environment

 **Easy On, Easy Off Cover**
100% cotton, machine washable

 **Breathable Sidewalls**
Cradles to prevent rollover

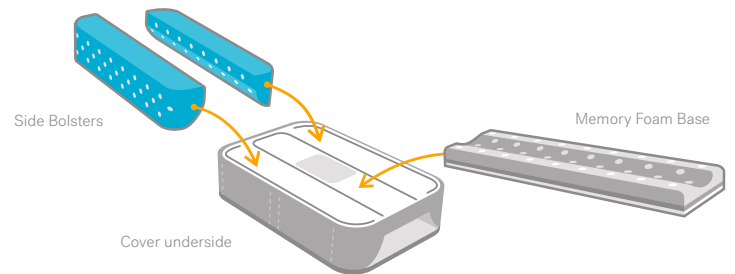

When assembled, the white, flat top of the Memory Foam Base faces baby. The tunnel should face down



CLEANING THE COVER

- Please wash the cover separately before use.
- For baby's safety, the cover is a single piece.
- Remove all foam cushions from their zippered pockets.
- Zip the cover closed before washing.
- Machine wash warm on the gentle cycle.
- Do not bleach.
- Air-dry. Do not tumble dry.



Cover surface 100% Cotton. Air mesh outer 100% Polyester.

CLEANING THE FOAM CUSHIONS

- Remove all foam cushions from the lounger cover.
- The foam cushions should not be submerged in water or placed in the washing machine or dryer.
- Use a damp cloth and mild soap to spot-clean the foam cushions.
- Leave the cushions in a well-ventilated area to dry completely before fitting into the cover.



Laminated polyurethane foam base. Polyurethane side bolsters.



SAFETY INSTRUCTIONS AND WARNINGS



- Improper use of this product could result in serious injury or death. Direct adult supervision is required.
- Use only on a firm, stable, flat surface. Never use on an elevated surface from which baby could fall.
- Never place baby face-down in the lounger.
- The lounger has a carry handle for your convenience. Never carry or lift the lounger with baby inside.
- Never place additional items in the lounger such as pillows, blankets or soft toys with baby. Additional items can pose a suffocation or strangulation risk.
- Keep the lounger away from walls or vertical structures to avoid baby becoming entrapped or suffocated within the gap. Never use within a crib, playpen or any other contained area.
- This lounger is not suitable for babies who can rollover or crawl or are otherwise mobile.
- Inspect regularly, do not use your lounger if damaged.
- Passes CPSIA safety standards; CPSIA sections 101 & 108. Standard consumer safety specification for toy safety, ASTM F963-11 clause 4.3.5. 16 CFR 1500.50 16 CFR 1632. Air-permeability as per BS4578 (U)
- El uso inadecuado de este producto puede provocar lesiones graves o la muerte. Utilizar bajo la supervisión directa de un adulto.
- Usar únicamente sobre una superficie firme, estable y plana. Nunca lo use sobre una superficie elevada desde la cual el bebé pueda caerse.
- Nunca coloque al bebé boca abajo en el nido.
- El nido tiene un asa de transporte para su comodidad. Nunca cargue o levante el nido con el bebé adentro.
- Nunca coloque objetos adicionales en el nido con el bebé, como almohadas, mantas o juguetes blandos. Los objetos adicionales pueden suponer un riesgo de asfixia o estrangulación.
- Mantenga el nido alejado de las paredes o estructuras verticales para evitar que el bebé quede atrapado o se asfixie dentro de ese espacio. Nunca lo use dentro de una cuna, corralito u otra área cerrada.
- Este nido no es adecuado para bebés que pueden darse vuelta o gatear, o que pueden desplazarse de cualquier manera.
- Inspeccione regularmente; no use el nido si está dañado.
- Aprueba las normas de seguridad de CPSIA; secciones 101 y 108 de CPSIA. Especificación estándar de seguridad del consumidor para la seguridad de los juguetes, ASTM F963-11 cláusula 4.3.5. 16 CFR 1500.50 16 CFR 1632. Permeabilidad al aire según BS4578 (Reino Unido). Certificado por Oeko-Tex, norma 100, clase 1 (UE).